

## 2-spindle double front drilling-/milling unit ER16 for front- and backworking



**Part Number** 7.073.550

**for** Star SV-20

Ratio 1:1  
 rpm at Input max. 6000 rpm  
 rpm at Output max. 6000 rpm  
 Torque at Output max. 13 Nm  
 Direction of Rotation   
 Scope of Delivery supplied with wrench, excluding collets

\* Actual size inscribed on the tool

Accessories Collets see Equipment for Toolholders Z2.1  
 Cover for internal coolant 1088334

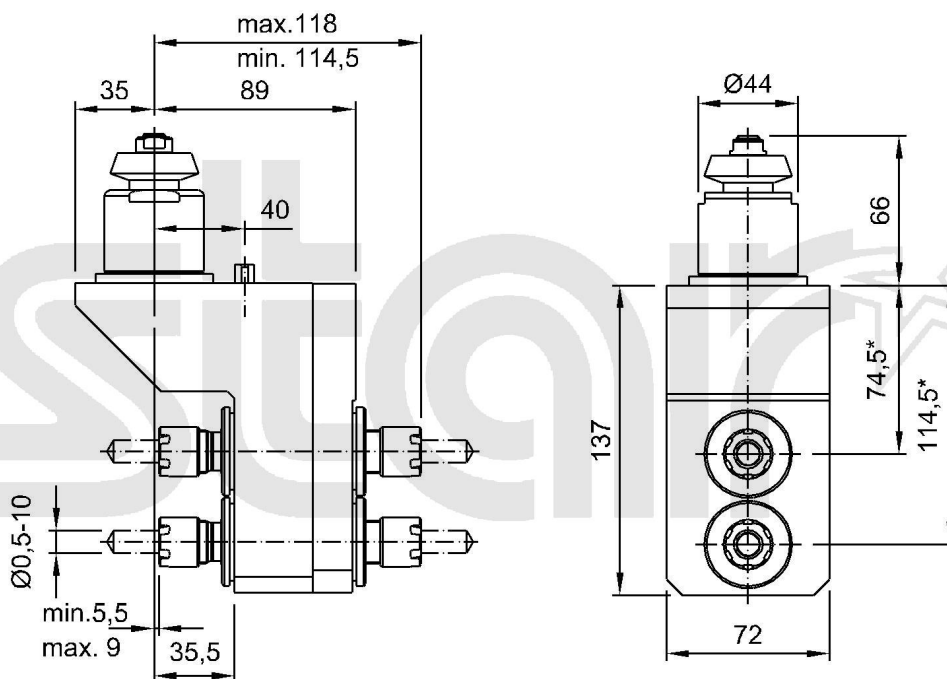

Technical Data Subject to Change

26.11.2007 25.11.2021

[www.star-tools.eu](http://www.star-tools.eu)